



RENTAL BUILDINGS, BARNES, & RV PARK

Saline County Expo Center, a hub of diverse events, has hosted an array of activities, including circuses, monster truck shows, concerts, and livestock shows showcasing rabbits, poultry, cattle, horses, donkeys, goats, sheep, and hogs. The Expo Center is also preferred for weddings, receptions, meetings, fundraisers, vendor fairs, and 4H events. We take pride in hosting the Tri-Rivers County Fair.

Our dedicated staff provides end-to-end services to ensure your event is successful. We set up tables and chairs, maintain cleanliness, and oversee tasks like unlocking doors, restroom maintenance, trash disposal, and handling spills. For your peace of mind, we'll take a final walk around with you before locking up.



AG HALL

Our historic indoor arena, built in 1924, features a dirt floor and measures approximately 90 feet wide by 190 feet long. It accommodates around 2,600 guests and is suitable for a diverse range of events. Vendor electric hookups are available on the north and west sides of the building.



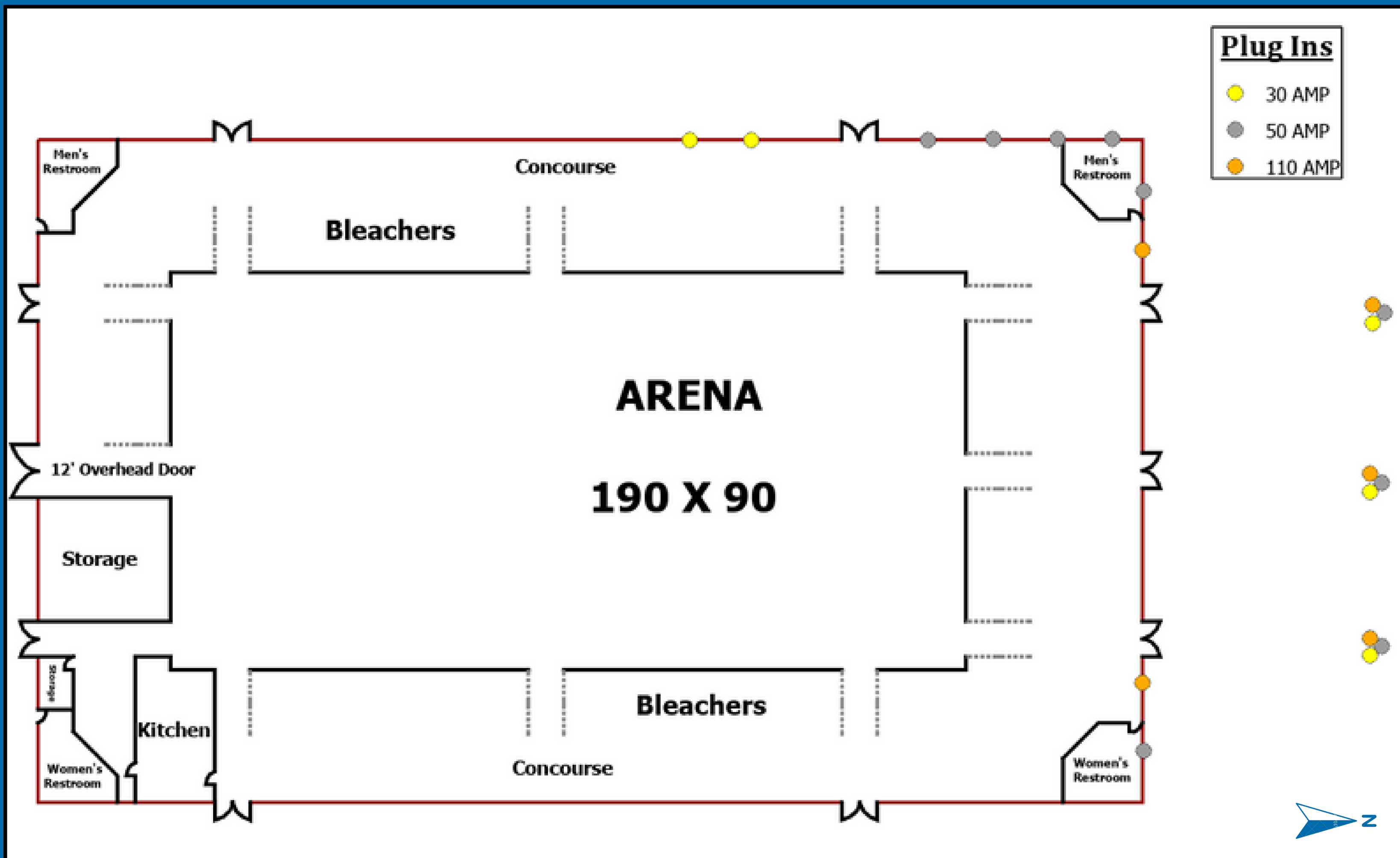

OUTSIDE ARENA

THE OUTDOOR WARM-UP PEN, 150 FEET BY 110 FEET, IS CONVENIENTLY LOCATED ON THE SOUTH SIDE OF AG HALL .



4-H BUILDING

The 4H Building, built in 1957, measures 138 feet by 124 feet. It has a stage, projector, and sound system.

Additional amenities include a commercial kitchen and smaller meeting areas that can be partitioned.



4-H Bldg Layout

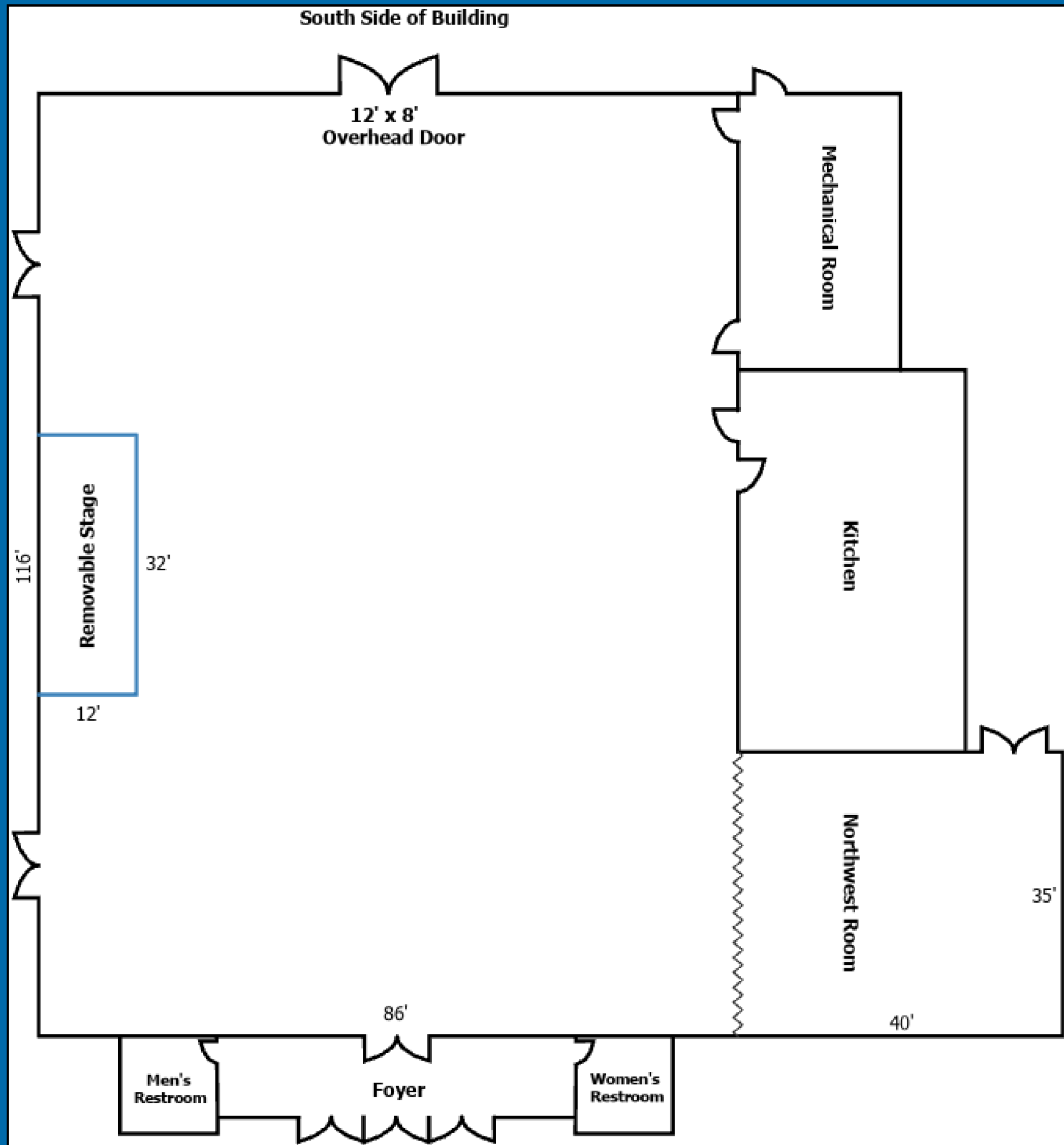

BARN 1

With 147 flexible horse stalls, this barn is suitable for a range of livestock. It includes accessible electric outlets and four water hydrants.





147 Stalls

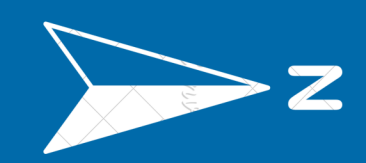

BARN 2

BUILT IN 1973, THIS
MULTIFUNCTIONAL BARN
ACCOMMODATES GOAT, SHEEP,
HOG AND RABBIT SHOWS. IT
INCLUDES RESTROOMS, SHOWERS
AND A GRADE A MILKING ROOM.



Barn 2 Layout



Plug Ins
● 110 AMP

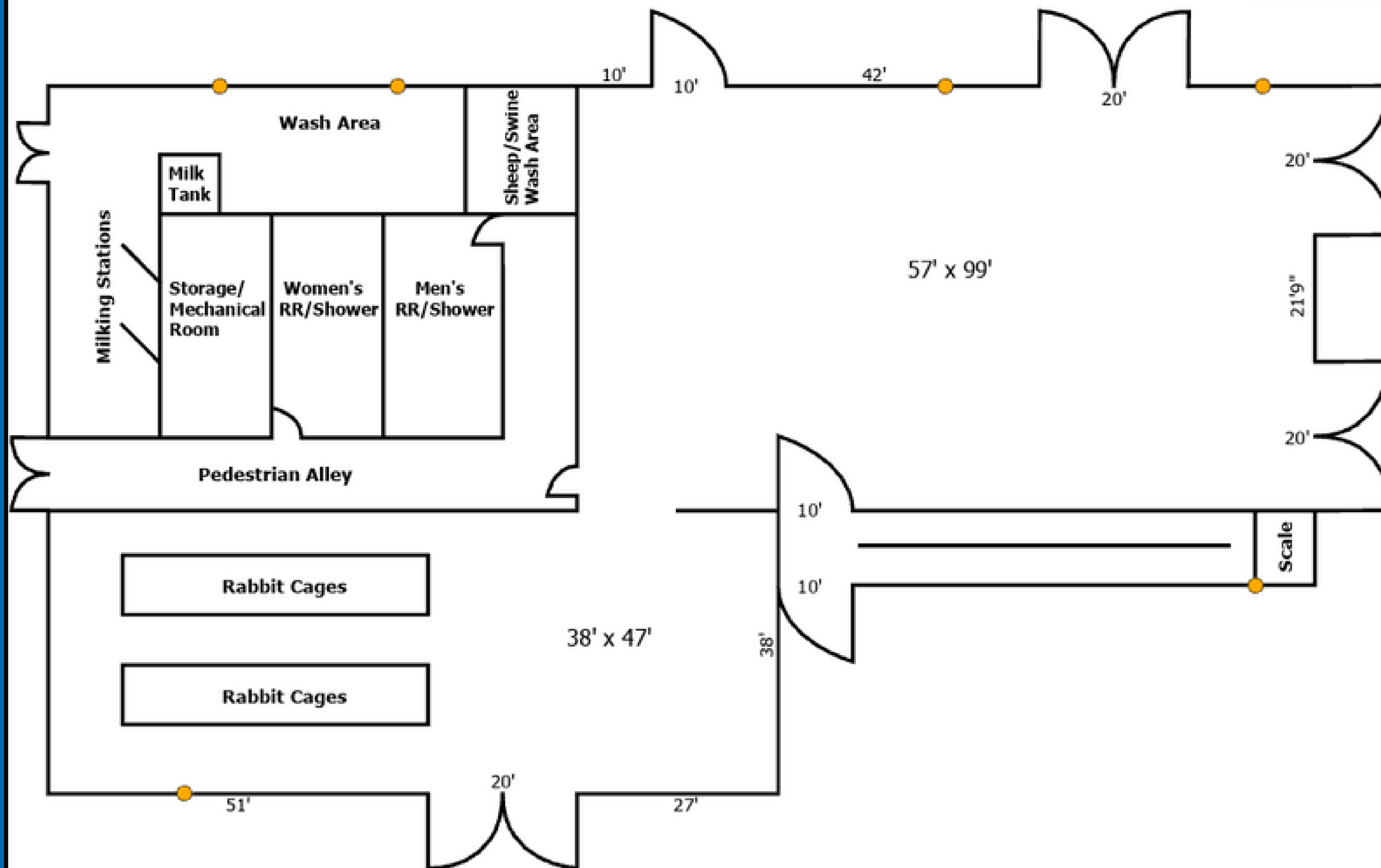

BARN 3



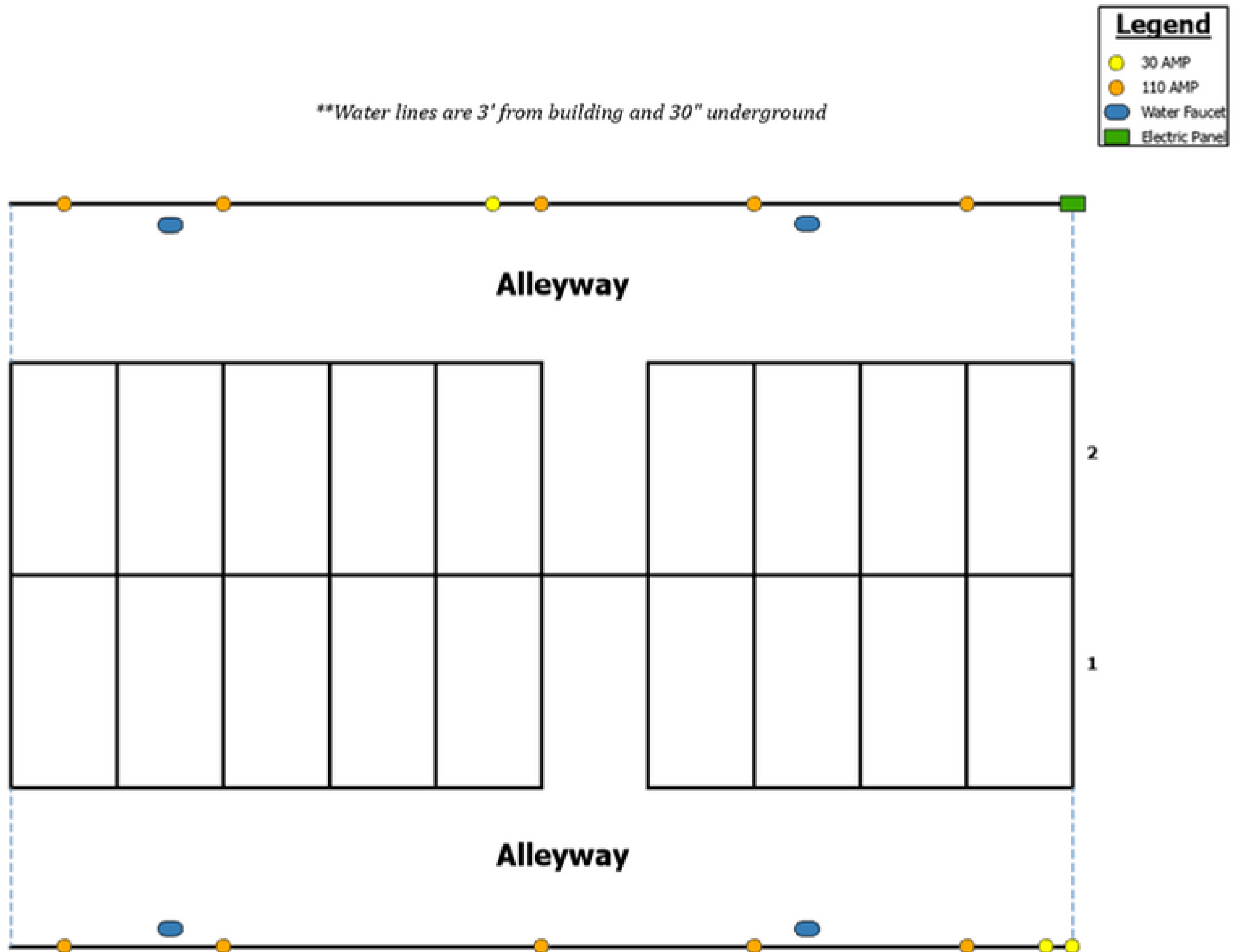

BARN 5

THIS BARN HOUSES 16 STALLS, EACH MEASURING 10 FEET BY 10 FEET BY 7 FEET. FACILITIES INCLUDE ELECTRICAL PLUGS AND A WATER FAUCET.



Barn 5 Layout



Plug Ins

● 30 AMP

● 110 AMP

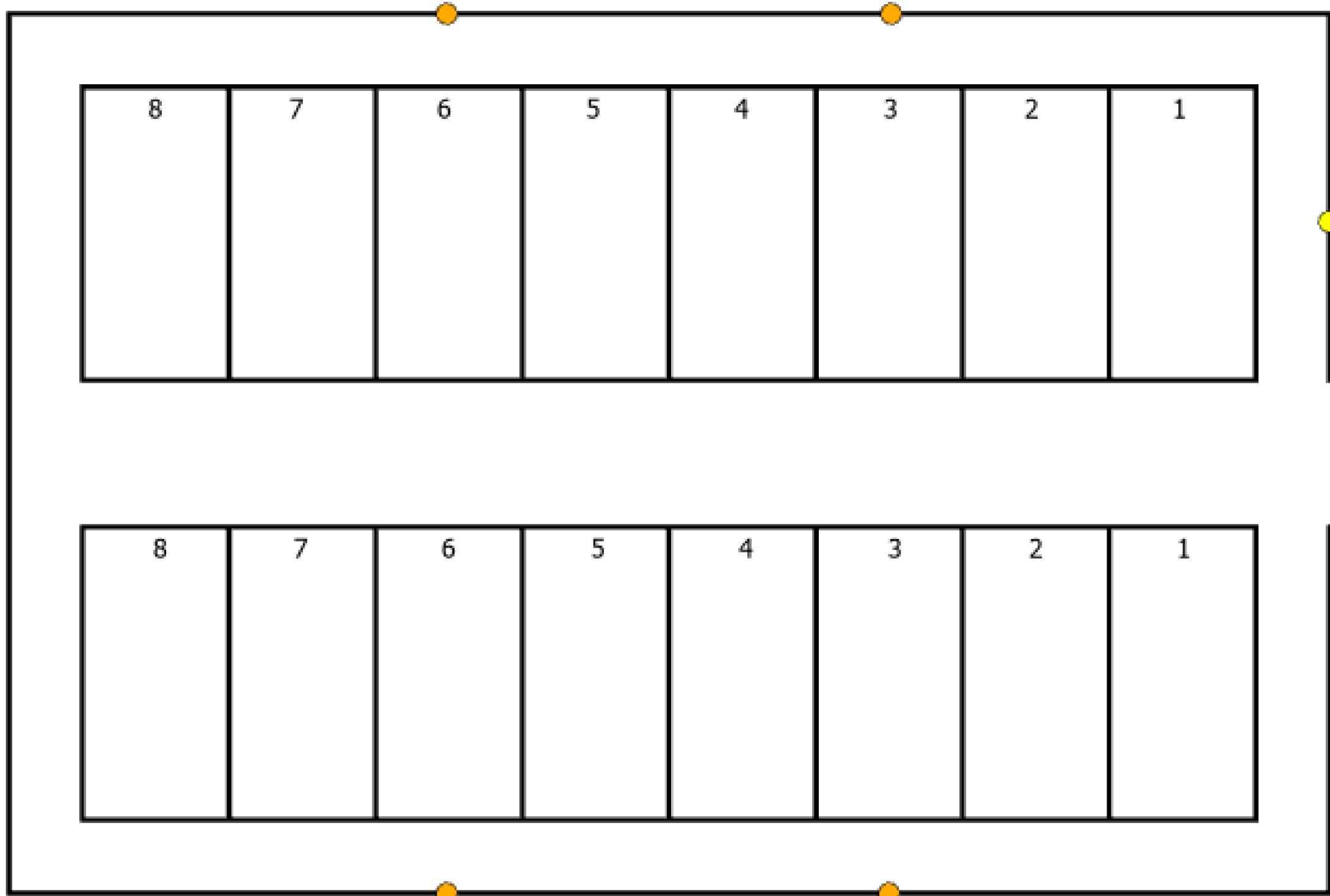

BARN 6

Offering 40 stalls, Barn 6 is equipped with 110V plugs and six 30-amp plugs.



Legend

- 30 AMP
- 110 AMP
- Water Faucet
- Electric Panel

*** Stalls can fold back to the middle to make tie-out for cattle.*

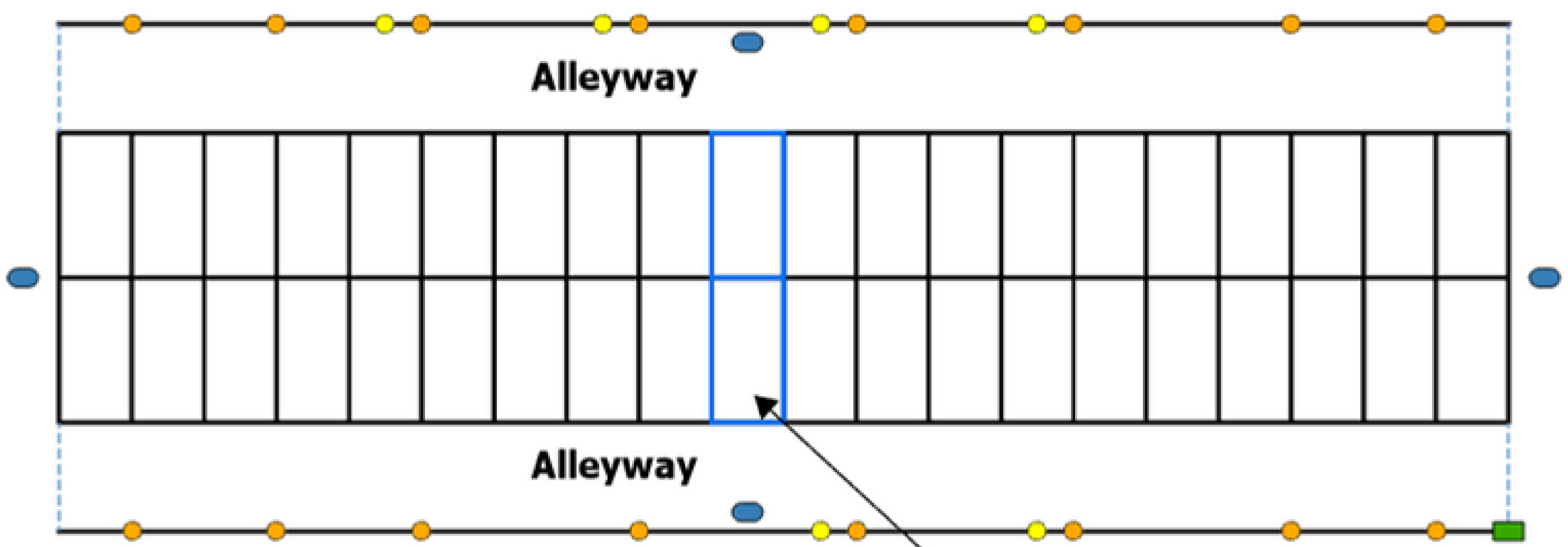

These stalls can be configured so there is a walkway through.



KENWOOD HALL

This versatile 60-by-120-foot metal building includes restrooms and a water fountain. Tables and chairs are provided.



Kenwood Hall Layout

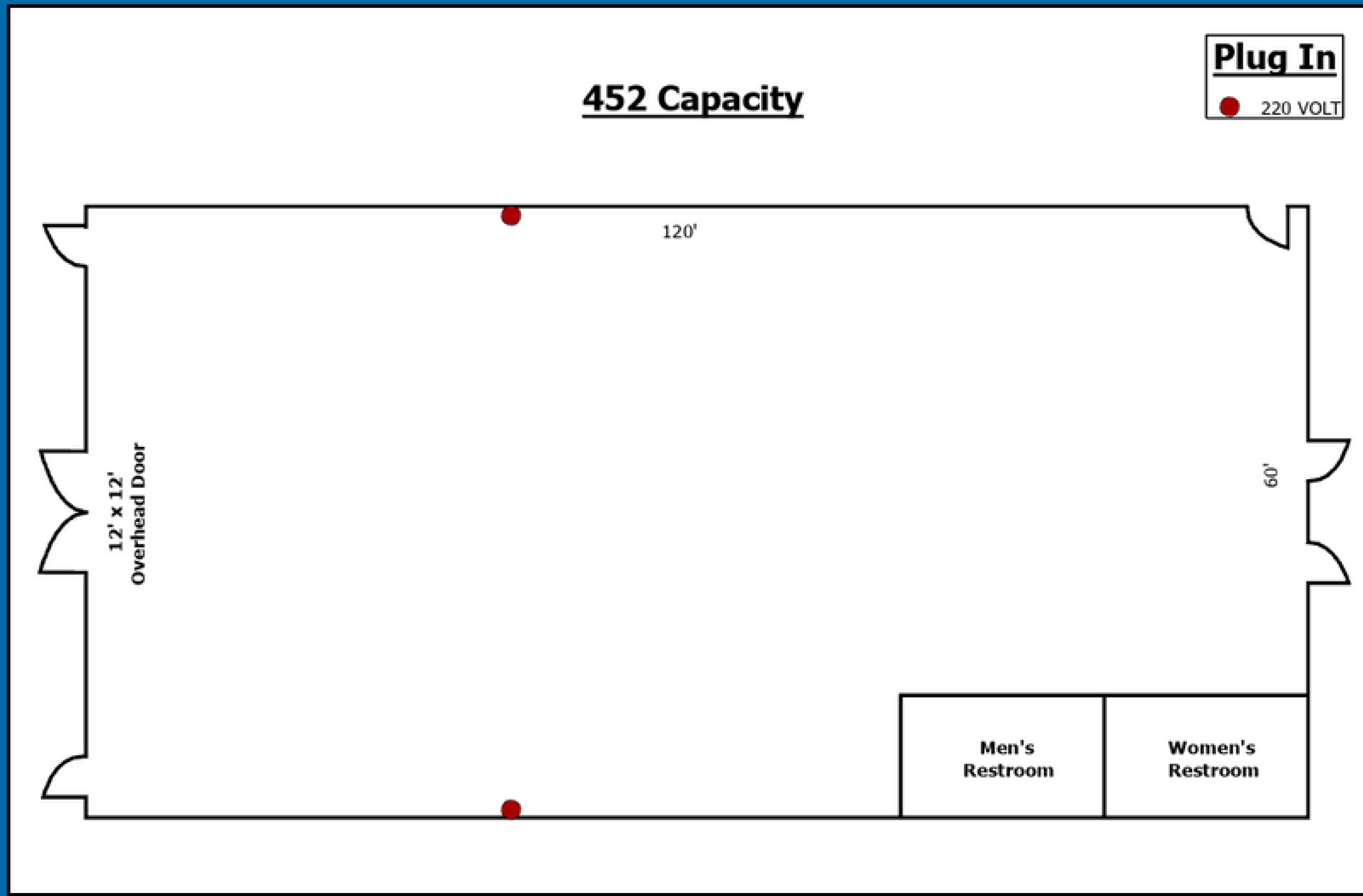

RV PARK

THE RV PARK PROVIDES 10 SPOTS WITH WATER AND ELECTRIC HOOKUPS (ONE 110 PLUG, ONE 30-AMP PLUG) FOR \$20 A NIGHT. SPACES ARE AVAILABLE ON A FIRST-COME, FIRST-SERVED BASIS.



MEET OUR STAFF



DAVID FLAHERTY II

FLAHERTYD@SALINECOUNTYKS.GOV

DIRECTOR EXPO/ NOXIOUS
WEED DEPT.



JEREMY BOWMAN

BOWMANJ@SALINECOUNTYKS.GOV

MAINTENANCE SUPERVISOR



BEV MONG

MONGB@SALINECOUNTYKS.GOV

ADMINISTRATIVE AIDE



900 Greeley Ave.
Salina, KS 67401

Office: 785.826.6532
Fax: 785.826.6534

www.salinecountyks.gov
Find us on Facebook

